

# SERIES AZ 9200

## SINGLE STAGE REGULATOR

Flow Rates to 2,000 SLPM (71 scfm)



- SS 316L construction
- High performance
- 10 µin. surface finish
- High flow with low particle generation
- 3/4 and 1 inch port size
- Tied diaphragm design
- Vacuum to 300 psig (21 bar) inlet
- Knob LOTO (refer to AP KL data sheet)
- Installation and operating instructions available at [www.aptech-online.com](http://www.aptech-online.com) in the Tech Briefs section

### Operating Parameters

Source pressure	AZ 9200	vacuum to 300 psig (21 bar)
Delivery pressure	AZ 9202	1 to 30 psig (0.07 to 2 bar)
	AZ 9206	2 to 60 psig (0.14 to 4 bar)
	AZ 9210	2 to 100 psig (0.14 to 7 bar)
	AZ 9215	5 to 150 psig (0.34 to 10 bar)
Proof pressure		150% of operating pressures
Burst pressure		300% of operating pressures

### Other Parameters

Inlet/outlet connectors	3/4 or 1 inch face seal or tube weld
Flow coefficient (Cv)	1.6
Internal volume	2.2 in <sup>3</sup> (36 cm <sup>3</sup> )
Operating temperature	-40° to +160°F (-40° to +71°C)
Surface finish	10 µin. (0.25 µm) Ra avg.
Inboard leakage	2 x 10 <sup>-10</sup> sccs
Outboard leakage	1 x 10 <sup>-9</sup> sccs He
Leakage across seat	4 x 10 <sup>-8</sup> sccs He
Installation	surface or panel (optional)
Supply pressure effect	7 psig per 100 psig source pressure change

### Materials

Series AZ 9200 S	
Wetted Parts	
Body, nozzle	stainless steel 316L*
Poppet	stainless steel 316L
Diaphragm	Ni-Cr-Mo alloy / UNS N06022
Finish	electropolished and passivated
Seat	PFA

All specifications subject to change without notice.

\*Please refer to product note PN 414 regarding single melt 316L SS material.

# SERVICE AND SUPPORT BEYOND COMPARE

## DIMENSIONAL INFORMATION

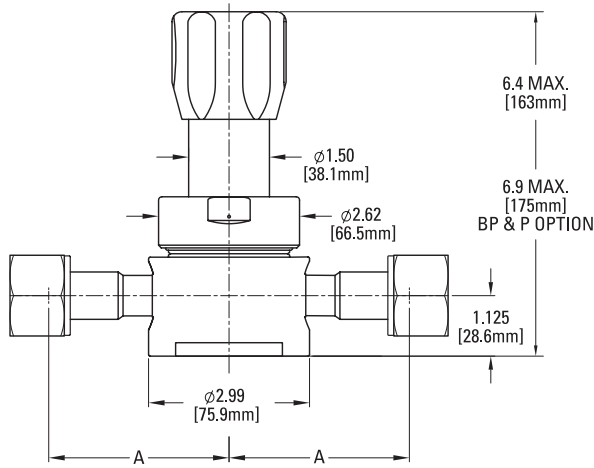

Connection	A	
	in	mm
FV12, MV12	3.39 ±.03	86.1

All dimensions in inches (mm).  
Metric dimensions are for reference only.

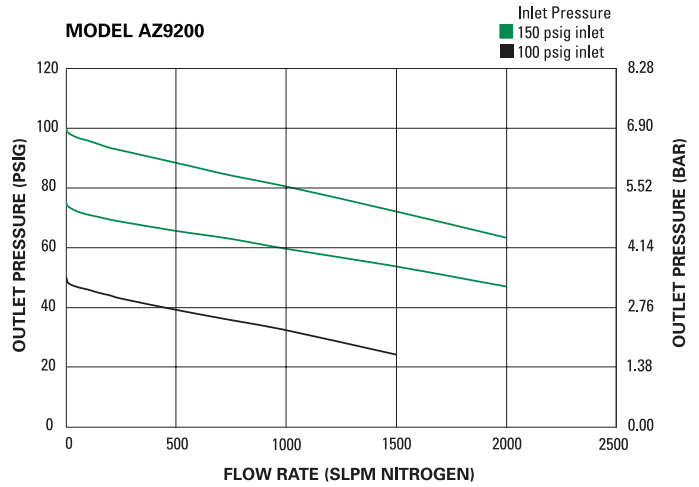

## PORTING CONFIGURATIONS

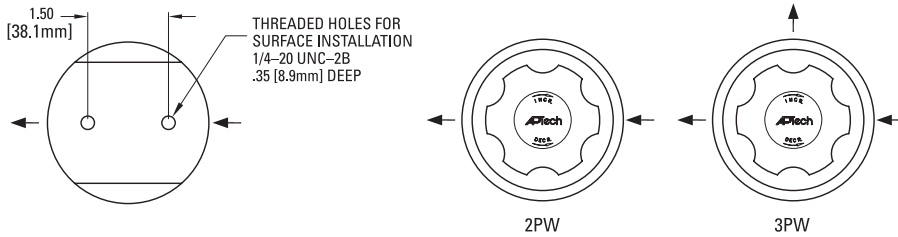

**CAUTION:** Product selection is the sole responsibility of the user, regardless of any recommendations or suggestions made by the factory. The user shall make selections based upon their own analysis and testing with regard to function, material compatibility and product ratings. Proper installation, operation and maintenance are also required to assure safe, trouble free performance.

## ORDERING INFORMATION

Sample Order Number

AZ 9210S 3PW FV12 FV12 1 P

AZ 9210 | Series

AZ 9202 = 1-30 psig (.07 to 2 bar)  
AZ 9206 = 2-60 psig (.14 to 4 bar)  
AZ 9210 = 2-100 psig (.14 to 7 bar)  
AZ 9215 = 5-150 psig (.34 to 10 bar)

S | Material

S = Stainless steel (SS)

3PW | Ports

2PW = 2 ports butt weld  
3PW = 3 ports butt weld

FV12 FV12 | Connections  
Inlet / Outlet

FV12 = 3/4 inch face seal female  
MV12 = 3/4 inch face seal male  
TW12 = 3/4 inch tube stub weld  
FV16 = 1 inch face seal female  
MV16 = 1 inch face seal male  
TW16 = 1 inch tube stub weld

1 | Delivery  
Gauge\*

0 = No gauge  
V3 = 30-0-30 psig/bar  
L = 30-0-60 psig/bar  
1 = 30-0-100 psig/bar  
H = 30-0-160 psig/bar

\* Standard gauge port is 1/4 inch face seal male (1/4 inch female available).

P | Options

P = Panel installation\*\*  
BP = Bonnet vent port  
KL = Knob LOTO  
(refer to AP KL data sheet)

\*\* Panel hole 1.56" diameter.

AP Tech has product options and variations which are not documented in data sheets. If you have a model number that is not defined by the ordering information, please consult the factory or your local representative.